



DELTA 8000 TAP RF

FR Notice d'installation
EN Installation instructions
DE Installationsanleitung

NL Installatie-instructies
ES Instrucciones para la instalación
IT Istruzioni per l'installazione



CONTENTS

EN

1/ Installation	4
2/ Association of the thermostat with the wireless gateway	7
3/ Thermostat configuration	8
4/ Setting the clock	12
5/ Locking down settings	14
6/ Return to initial settings	15
6.1 Initialising the thermostat parameters	15
6.2 Deleting the association of the thermostat with the wireless gateway	16
7/ Troubleshooting	18
8/ Technical characteristics	19

1/ INSTALLATION

Since the temperature measurement sensor is inside the box, you must install the thermostat:

- wall-mounted or placed on a shelf or a piece of accessible furniture at a height of 1.50 m.
- away from heat sources (fireplaces, sunlight) and draughts (windows, doors)

IMPORTANT: Do not install the thermostat on a wall in contact with the outdoors or with an unheated room (e.g. garage, etc.)

- 1 Separate the box from its base unit by pushing the pin using a screwdriver.
- 2 Remove the batteries.
- 3 Attach the box with suitable screws to the mount or mount the thermostat onto its base unit.
- 4 Insert the batteries.
- 5 Mount the thermostat front panel.

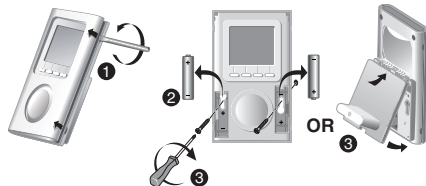

EN

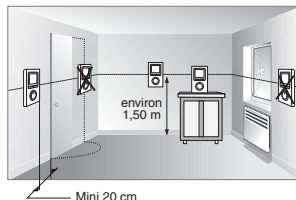

2/ ASSOCIATION OF THE THERMOSTAT WITH THE WIRELESS GATEWAY

- ① **On the gateway:** Press and hold the left hand side button for 3 seconds until LED 1 flashes, then release.

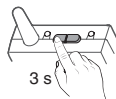

- ② **On the thermostat:**
Turn the selector knob to

- ③ Press and hold the second button from the left for 3 seconds, then release.

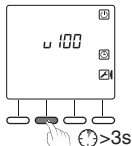

- ④ The screen displays **Ln01**.
Press **OK** to display the number of associated products.

- ⑤ Press and hold **OK** for 3 seconds to open the mode for finding products to be associated.

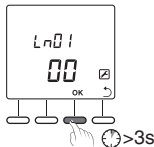

- ⑥ The display flashes, indicating the number of products found. When the flashing stops, press **OK** to confirm. LED 1 on the wireless gateway stops flashing.

- ⑦ The screen displays **CF20**.
Press **OK** to open the setting, then press + and - to select the output with which the room thermostat will be associated. Confirm with **OK**.



- ⑧ The screen displays **CF21**.
Press **OK** to open the setting, then press + and - to select the type of transmitter. Confirm with **OK**.

- ⑨ The screen displays **CF22**.
Press **OK** to open the setting, then press + and - to select the limitation value. Confirm with **OK**.



Press or turn the selector knob to exit the active mode.

CF20	Output number	1 to 16 depending on the system.
CF21	Transmitter type	0 Underfloor heating (by default)
		1 Heater
CF22	Heating percentage limitation	From 10 to 100% in increments of 10 (100% = No limitation, by default).

3/ THERMOSTAT CONFIGURATION

- 1 Turn the selector knob to .
 - 2 Press OK.
 - 3 The screen displays CF01.
- Press + or - to select the menu.
 - Press OK to enter the setting mode, then + and - to perform the setting.

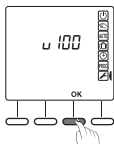

CF01	Correction of the measured temperature	+/- 5°C in increments of 0.1°C (0°C by default)	
CF02	Temperature displayed in normal mode	0	Setting display (default selection)
		1	Display of the measured temperature.
CF03 ⁽¹⁾	Ban on the Cool regulation on the Thermostat's thermal zones (if SW2 = ON on the technical unit)	0	No ban (default selection)
		1	Ban
CF04	Display the status (ON) of the associated output	0	No (default selection)
		1	Yes
CF05 ⁽²⁾	Thermostat type	0	Zone thermostat (default selection)
		1	Master thermostat

⁽¹⁾CF03 only appears in Heat/Cool generation mode (SW2=ON, refer to the technical unit manual) and for underfloor heating (CF21=0).



⁽²⁾CF05: The Master thermostat enables centralised ON/OFF and HEAT/COOL operations to be performed (according to the technical unit's configuration).

CF05

	Master thermostat	Zone thermostat
Temperature management	Controlled zone	Controlled zone
On/Off management	All zones	Controlled zone
HEAT/COOL mode management	All zones	-

3/ THERMOSTAT CONFIGURATION

EN

CF06	Activation of the door/window magnetic contact function (the room thermostat switches to Frost Protection mode if the door/window magnetic contact is activated).	0	Not activated
		1	Active (default selection) - Display of the  symbol
CF07	This menu is only available if CF06 = 1. The  symbol will flash in the event of detection.	0	Not flashing
		1	Flashes in case of detection (default selection)
CF08	'Presence detection' function (the thermostat setting is lowered if no presence is detected).	0	Not activated
		1	Activated (default selection)
CF10	Displays the time and date in the 12h/24h format	0	12h (AM/PM)
		1	24h (default selection)
CF11	Standby mode	0	Display off after a 10-second time-out period
		1	Display illuminated continuously (default selection)
		2	Display off (10-second time-out period) from 23.00 to 6.00. Display on from 6.00 to 23.00.
CF12	Backlighting	0	Deactivated
		1	When activated, it goes out after a 5-second time-out period (default)
CF20	Output number	1 to 16 depending on the system. '-' is displayed if none are allocated.	
CF21	Transmitter type	0	Underfloor heating (by default)
		1	Heater
CF22	Heating percentage limitation	From 10 to 100% in increments of 10 (100% = No limitation, by default).	

4/ SETTING THE CLOCK

- 1 Turn the selector knob to .
- 2 Set the year with + and - and confirm with OK.
- 3 Set the day and month with + and - and confirm with OK.
- 4 Set the hour value with + and - and confirm with OK.
- 5 Set the minutes value with + and - and confirm with OK.
- 6 Back to the AUTO, Manual or Shutdown mode.

Press  to return to the previous setting..

You can decide not to use the calendar function (no automatic changeover between summer and winter).

In this case, when you select the year, select '----' by pressing on -.

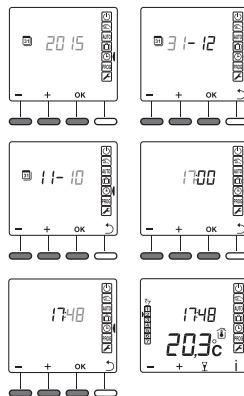

5/ LOCKING DOWN SETTINGS

From the **AUTO**, **OFF**, **MANUAL** or **LOCK** modes.

Press and hold the 'i' button for 5 seconds.
The **i** symbol appears.

In Lock mode, only the Information button (i) is active.

To unlock, press and hold the i button for 5 seconds.
The **i** symbol disappears.

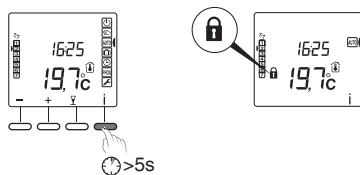

6/ RETURN TO INITIAL SETTINGS

6.1 INITIALISING THE THERMOSTAT PARAMETERS

EN

This menu restores the system to factory settings.

- 1 From the **OFF** (or **OFF**) mode.
Simultaneously press the 1st and 4th buttons from the left (**i**) for 10 seconds. Release.

- 2 The screen displays **rSt1**.
Press and hold **OK** for 3 seconds until the rSt1 display flashes.
Release.

The system automatically returns to **STOP** mode.

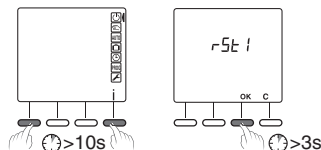

6/ RETURN TO INITIAL SETTINGS

6.2 DELETING THE ASSOCIATION OF THE THERMOSTAT WITH THE WIRELESS GATEWAY

- 1 Turn the selector knob to .
- 2 Press and hold the 2nd button from the left for 3 seconds.
Release.
- 3 The screen displays **Ln01**.
Press + to display **Ln03**.
- 4 Press **OK**.
The screen displays the number of products found.
Press and hold **OK** for 3 seconds.
The display flashes for 2 seconds and returns to 00. Release.

Press  or turn the selector knob to exit the active mode.

If the display does not return to 00, this means that some products are not responding. To delete them, start again with Ln04 (3).

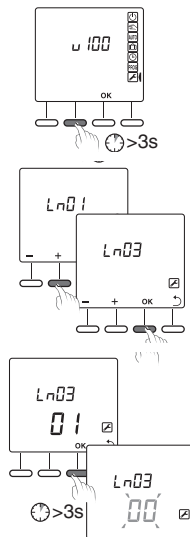

7/ TROUBLESHOOTING

- **The screen displays the  symbol.**
The batteries are spent. Replace the batteries

When a defect is detected on the system, the symbol  flashes on the thermostat display.
Press 'i' to display the type of defect.

Error messages

Error32	Address error. Several products were assigned to the same output (CF20).
Error33	Thermostat internal sensor shorted
Error34	Thermostat internal sensor cut off
Error35	Error on the outdoor sensor associated with the thermostat channel

8/ TECHNICAL CHARACTERISTICS

- 2 x 1.5V LR03/AAA alkaline batteries (included)
- Class III insulation
- 868 MHz transmission frequency, class I (standard EN 300 220)
- Wireless remote control device
- Wireless range from 100 to 300 metres outside, varies depending on the associated equipment (the range can vary depending on the installation conditions and the electromagnetic environment).
- Dimensions: 81 x 135 x 22 mm
- Degree of protection: IP 30
- Surface-mounted or on flush-mounting box
- Installation in an environment with normal pollution levels
- Storage temperature: -10°C to +70°C
- Operating temperature: 0°C to +40°C

EN



www.deltadore.com



2704584 Rev.01