



DELTA 8000 TAP BUS

FR Notice d'installation
EN Installation instructions
DE Installationsanleitung

NL Installatie-instructies
ES Instrucciones para la instalación
IT Istruzioni per l'installazione



CONTENTS

EN

1/ Installation	4
2/ Association of the thermostat with the technical unit.	6
3/ Thermostat configuration	8
4/ Setting the clock	12
5/ Locking down settings	14
6/ Return to initial settings	15
6.1 Deleting the association of the thermostat with the technical unit	15
6.2 Deleting all the associations with the technical unit	16
6.3 Initialising the thermostat parameters	17
7/ Troubleshooting	18
8/ Technical characteristics	19

1/ INSTALLATION

Since the temperature measurement sensor is inside the box, you must install the thermostat flush-mounting box:

- on an accessible wall at a height of 1.50 m
- away from heat sources (fireplaces, sunlight) and draughts (windows, doors)

IMPORTANT: Do not install the thermostat on a wall in contact with the outdoors or with an unheated room (e.g. garage, etc.) The sleeve output in the flush-mounting box must be blanked off (with mastic) in order to avoid unwanted air movements that could bias the sensor reading.

- 1 Switch off the installation.
- 2 Separate the box from its base unit by pushing the pin using a screwdriver.
- 3 Unscrew the locking screw (captive screw).
- 4 Separate the box from its base unit.
- 5 Connect the bus from the technical unit to the terminal located on the base unit, then attach the box to the flush-mounting box (centre distance 60 mm).
Note: the base unit must be attached using 3 screws.
- 6 7 8 Refit the thermostat back on its base unit.
- 9 Switch the installation back on.

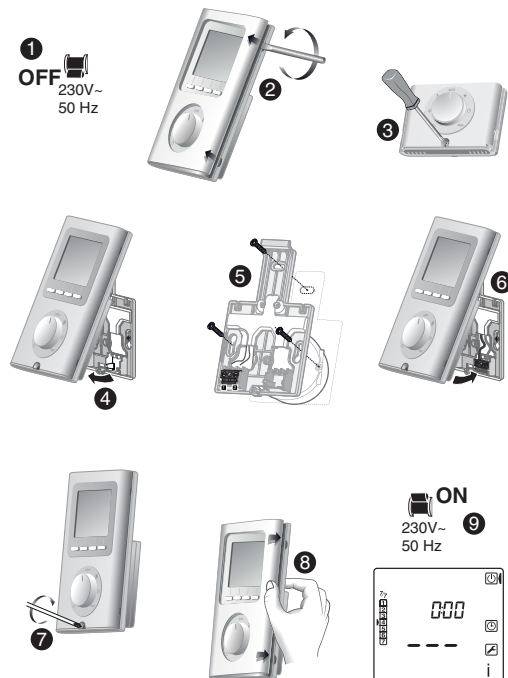

2/ ASSOCIATION OF THE THERMOSTAT WITH THE TECHNICAL UNIT.

- 1 Turn the selector knob to .
- 2 Press and hold the 2nd button from the left for 3 seconds. Release.
- 3 The screen displays **Ln01**. Press OK to confirm the association.
- 4 The screen displays **CF20**. Press OK to open the setting, then press + and - to select the output to which the room thermostat will be associated. Confirm with OK.
- 5 The screen displays **CF21**. Press OK to open the setting, then press + and - to select the type of transmitter. Confirm with OK.
- 6 The screen displays **CF22**. Press OK to open the setting, then press + and - to select the limitation value. Confirm with OK.

Press  or turn the selector knob to exit the active mode.

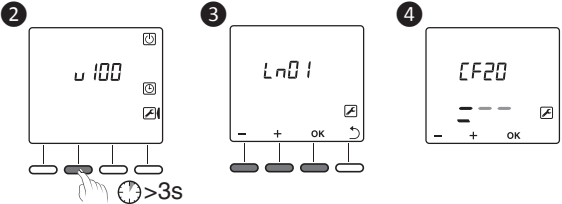

CF20	Output number	1 to 16 depending on the system. '--' is displayed if none are allocated.	
CF21	Transmitter type	0	Underfloor heating (by default)
		1	Heater
CF22	Heating percentage limitation	From 10 to 100% in increments of 10 (100%= No limitation, by default).	

3/ THERMOSTAT CONFIGURATION

- 1 Turn the selector knob to .
- 2 Press OK.
- 3 The screen displays CF01.
 - Press + or - to select the menu.
 - Press OK to enter the setting mode, then + and - to perform the setting.

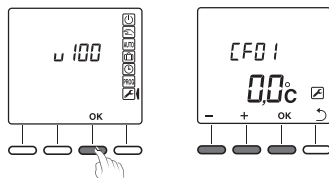

CF05	Master thermostat	Zone thermostat
Temperature management	Controlled zone	Controlled zone
On/Off management	All zones	Controlled zone
HEAT/COOL mode management	All zones	-



CF01	Correction of the measured temperature	+/- 5°C in increments of 0.1°C (0°C by default)	
CF02	Temperature displayed in normal mode	0	Setting display (default selection)
		1	Display of the measured temperature.
CF03 ⁽¹⁾	Ban on the Cool regulation on the Thermostat's thermal zones (if SW2 = ON on the technical unit)	0	No ban (default selection)
		1	Ban
CF04	Display the status (ON) of the associated output	0	No (default selection)
		1	Yes
CF05 ⁽²⁾	Thermostat type	0	Zone thermostat (default selection)
		1	Master thermostat

⁽¹⁾CF03 only appears in Heat/Cool generation mode (SW2=ON, refer to the technical unit manual) and for underfloor heating (CF21 =0).

⁽²⁾CF05: The Master thermostat enables centralised ON/OFF and HEAT/COOL operations to be performed (according to the technical unit's configuration).

3/ THERMOSTAT CONFIGURATION

EN

CF06	Activation of the door/window magnetic contact function (the room thermostat switches to Frost Protection mode if the door/window magnetic contact is activated).	0	Not activated
		1	Active (default selection) - Display of the  symbol
CF07	This menu is only available if CF06 = 1. The  symbol will flash in the event of detection.	0	Not flashing
		1	Flashes in case of detection (default selection)
CF08	'Presence detection' function (the thermostat setting is lowered if no presence is detected).	0	Not activated
		1	Activated (default selection)
CF10	Displays the time and date in the 12h/24h format	0	12h (AM/PM)
		1	24h (default selection)
CF11	Standby mode	0	Display off after a 10-second time-out period
		1	Display illuminated continuously (default selection)
CF12	Backlighting	0	Deactivated
		1	When activated, it goes out after a 5-second time-out period (default)
CF20	Output number	1 to 16 depending on the system. '--' is displayed if none are allocated.	
CF21	Transmitter type	0	Underfloor heating (by default)
		1	Heater
CF22	Heating percentage limitation	From 10 to 100% in increments of 10 (100%= No limitation, by default).	

4/ SETTING THE CLOCK

- 1 Turn the selector knob to .
- 2 Set the year with + and - and confirm with OK.
- 3 Set the day and month with + and - and confirm with OK.
- 4 Set the hour value with + and - and confirm with OK.
- 5 Set the minutes value with + and - and confirm with OK.
- 6 Back to the AUTO, Manual or Shutdown mode.

Press  to return to the previous setting.

You can decide not to use the calendar function (no automatic changeover between summer and winter).
In this case, when you select the year, select '----' by pressing on -.

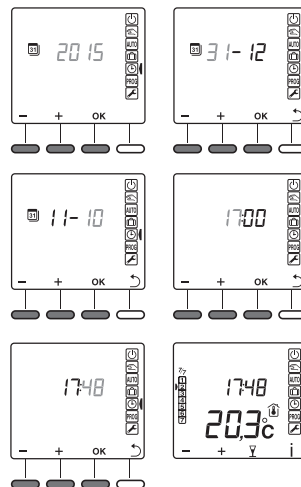



5/ LOCKING DOWN SETTINGS

From the , ,  or  modes.

Press and hold the 'i' button for 5 seconds. *The  symbol appears.*

In Lock mode, only the Information button () is active.

To unlock, press and hold the  button for 5 seconds.
The  symbol disappears.

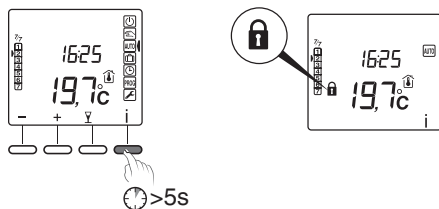

6/ RETURN TO INITIAL SETTINGS

6.1 DELETING THE ASSOCIATION OF THE THERMOSTAT WITH THE TECHNICAL UNIT

EN

- 1 Turn the selector knob to .
- 2 Press and hold the 2nd button from the left for 3 seconds. Release.
- 3 The screen displays Ln01. Press OK.
- 4 The screen displays CF20. Press OK to open the setting, then press + and - to select 'CF20 = --'
- 5 Press OK.

Press  or turn the selector knob to exit the active mode.

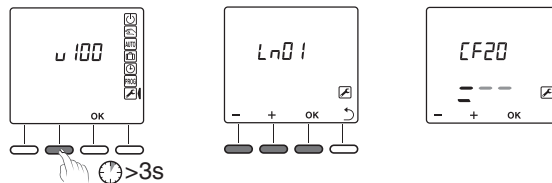

6/ RETURN TO INITIAL SETTINGS

6.2 DELETING ALL THE ASSOCIATIONS WITH THE TECHNICAL UNIT

- 1 Turn the selector knob to . Press and hold the 2nd button from the left for 3 seconds for 5 seconds. Release.
- 2 The screen displays **Ln01**. Press + to display **Ln05**.
- 3 Press OK. The screen displays **rSt**. Release. Press and hold OK for 3 seconds. *rSt flashes for 2 seconds*. Release.
- 4 Turn the selector knob to exit.

Press  or turn the selector knob to exit the active mode.

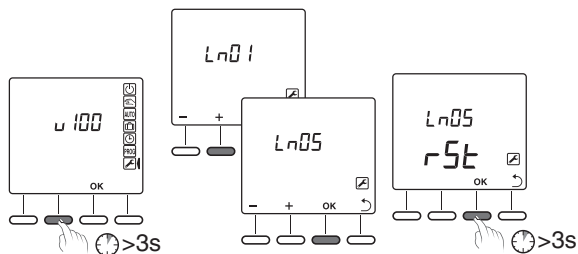

6.3 INITIALISING THE THERMOSTAT PARAMETERS

EN

This menu restores the system to factory settings.

- 1 From the  (or OFF) mode. Simultaneously press the 1st and 4th buttons from the left (**i**) for 10 seconds. Release.
- 2 The screen displays **rSt1**. Press and hold OK for 3 seconds until the rSt1 display flashes. Release.

The system automatically returns to OFF mode.

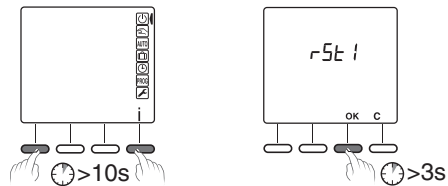

7/ TROUBLESHOOTING

When a defect is detected on the system, the symbol  flashes on the thermostat display.

Press 'i' to display the type of defect.

Error messages

Error 32	Address error. Several products were assigned to the same output (CF20).
Error 33	Thermostat internal sensor shorted
Error 34	Thermostat internal sensor cut off
Error 35	Error on the outdoor sensor associated with the thermostat channel

8/ TECHNICAL CHARACTERISTICS

- Power supply by the bus, 24V
- Clock backup during power failure:
10 hours (by capacitor)
- Bus Input/output 2 wires
- Class III insulation
- Dimensions: 81 x 135 x 22 mm
- Degree of protection: IP 30
- Surface-mounted or on flush-mounting box
- Installation in an environment with normal pollution levels
- Storage temperature: -10°C to +70°C
- Operating temperature: 0°C to +40°C



www.deltadore.com



2704579 Rev.01