

Installation & User Manual

For 24V-AC Thermostat Wiring

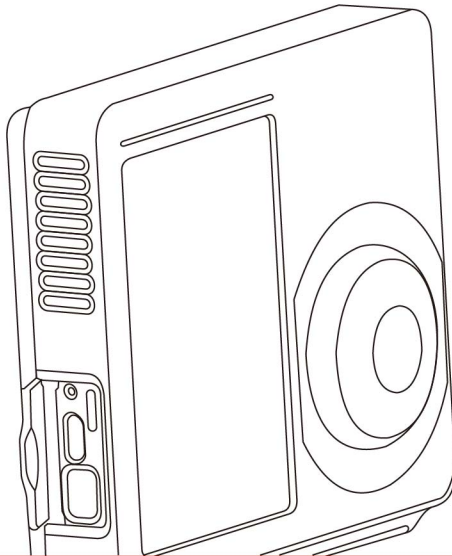

Warning: Failure to follow and read all instructions before installing or operating this device may cause personal injury and/or property damage.

In the Box

- Wi-Fi Thermostat
- Two screws and anchors
- Flathead screwdriver
- Wire labels
- Jumper wire
- User manual
- Registration card

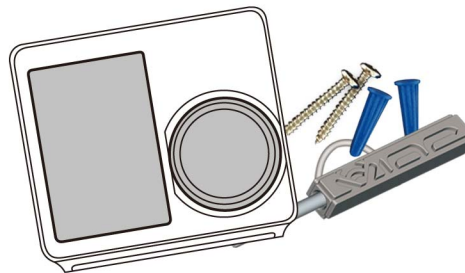

Some features require an internet connection and a user account. Features, specifications, and appearance are subject to change without notice.

PAGE 01

Check Compatibility First

For conventional (gas/oil/electric) and heat-pump systems

> 1-Heat & 1-Cool > Heat Only > Cool Only

* C-Wire required to power the thermostat

Getting started

The TJ-610B thermostat is designed to work on most 24V low voltage heating and cooling systems such as gas and oil furnaces, heat pumps, and single-stage systems

Professional installation recommended for:

- Dual fuel systems (heat pump with furnace)
- Separate humidifiers and dehumidifiers

Turn Power Off

Please turn off the furnace's main power at the switchbox before beginning the installation process.



Warning: Failure to turn off power may result in electrical shock and/or system damage.

1 Remove the Old Thermostat

Before removing the wires from the thermostat or wall plate, take a photo of all wires for reference, then label each wire according to the terminal codes.

Disconnect the wires from the old thermostat one by one. **Do not let wires fall back into the wall.** Remember, the power to your HVAC system must be turned off.

After labeling the wires, we recommend securing them to an object such as a pen or clip to prevent them from falling back into the wall.



PAGE 02

2

Connect the New Wall Plate

Warning: Use caution when securing and routing wires to prevent possible shortage to adjacent terminals.

Insert all wires vertically from the open socket into the proper terminal. Ensure each wire is inserted into the matching terminal (refer to the photo taken previously if needed). Use the supplied flathead screwdriver to fasten each wire. Pull wires gently to ensure wires are securely fastened.

When all wire connections have been completed, place any surplus wireage back inside the wall.

*For the heat pump system, if the old thermostat has separate wires for Aux-Heating and Emergency-Heating, twist the wires together and connect them to the W/E terminal.

The following are typical wiring diagrams for common systems:

R - Power	G - Fan	W - Heating
Y - Cooling	C - Power	O/B - Reverse Valve

Conventional Heating/Cooling system with C wire

You may substitute the C wire with a spare wire if one is available.

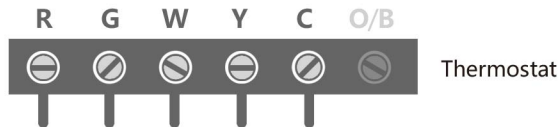

Conventional system without the C or spare wire (also commonly called a 4-wire system)

- 1) At the thermostat, connect C with the G wire;
- 2) **At the furnace's wiring terminal**, move the G wire to the C terminal, then use the included jumper wire to connect G with Y

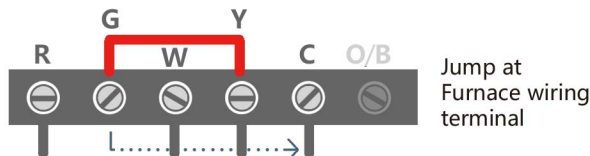

PAGE 03

Heat Pump with or without Emergency Heating

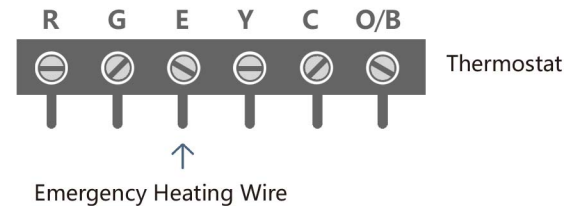

Heat only 3-Wire system

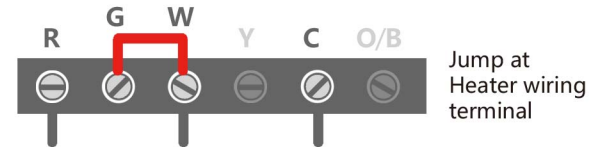

Cool only 3-Wire system

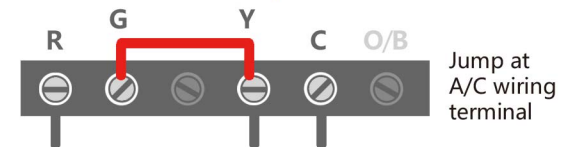

For heating or cooling only systems, if you just have two wires (no C wire), you need to have a USB adapter to power the thermostat.

3

Mount the New Wall Plate

Use the enclosed screws and anchors to mount the new wall plate. In most cases, you can utilize the same mounting position of your old thermostat. Be sure to check the alignment of your wall plate pre and post installation of the thermostat unit.



PAGE 04

4 Attach TJ-610 to the Wall

First align the two clips on the back of the TJ-610 into the corresponding slots on the top of the wall plate.

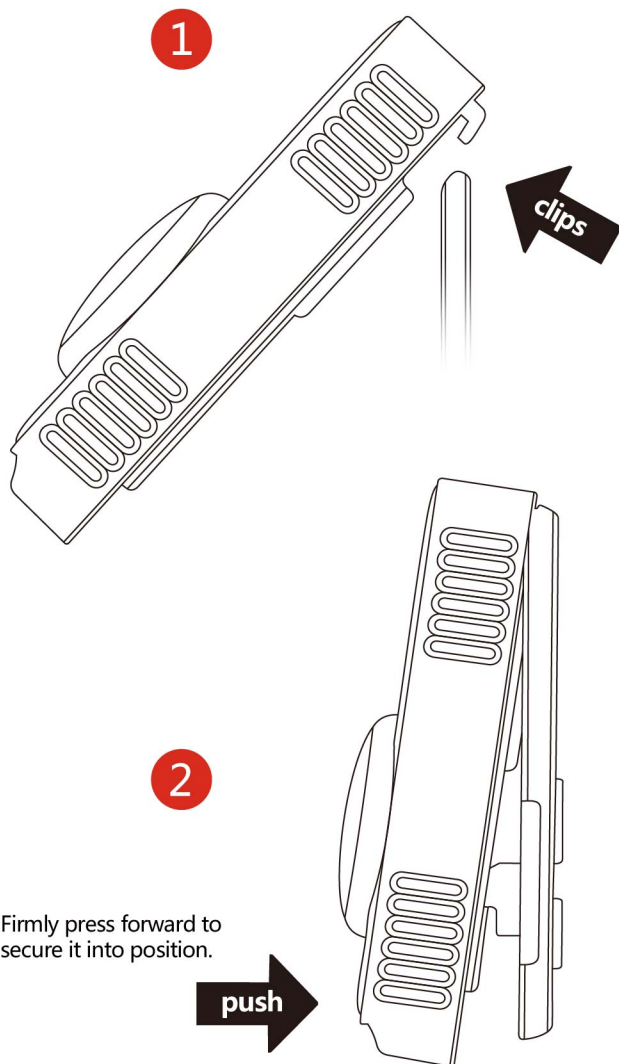

5 Power On and Enjoy!

Ensure the C-wire (if used) is properly connected to the furnace and thermostat. Properly secure and lock the furnace door into place. Switch the power back on for the heating/cooling system at the main switch box.

If you have done everything correctly, your thermostat should power on and prompt you to start the setup. If you are having trouble, please refer to our help guide for additional support.

Thank you for choosing Vine Smart Home. Enjoy the savings and comfort of owning one of our smart thermostats!

Main Screen

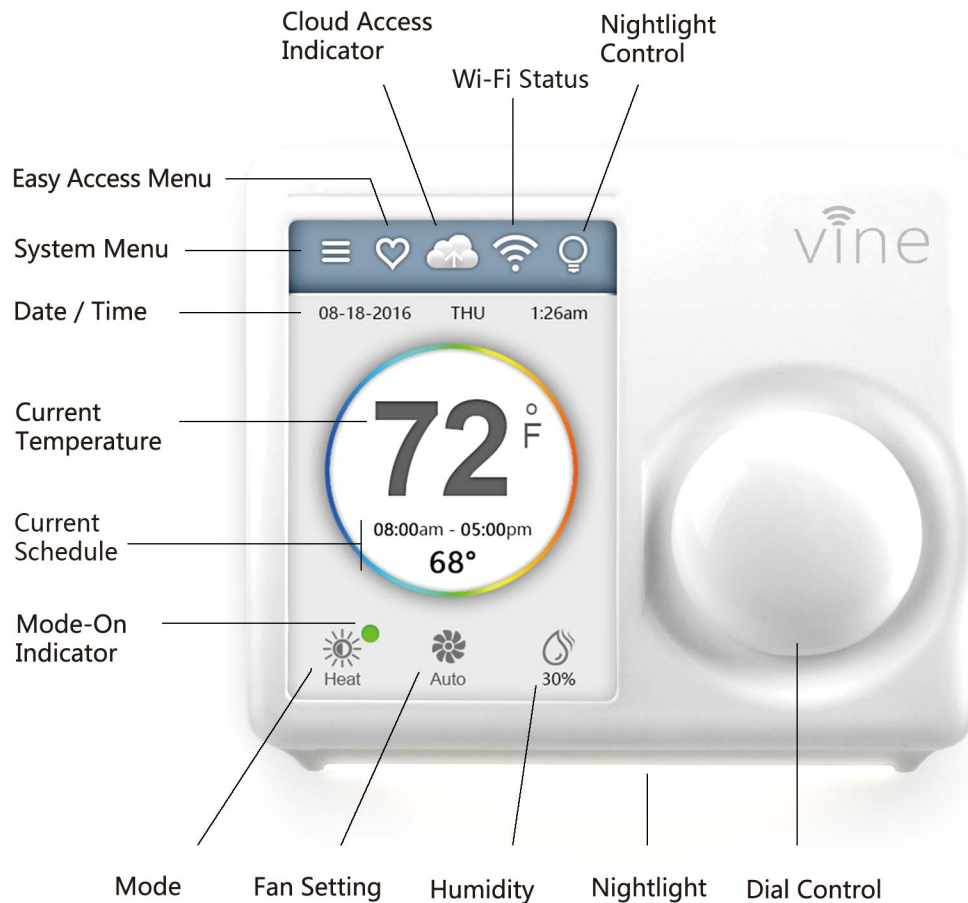

Initialization

For a quick and easy way to begin using your new smart thermostat, the device will automatically direct you to the Initialization Setup process once it's turned on for the first time.

MENU ACCESS

- Initialization**
- > Main Menu
 - > Activation
 - > Initialization

1. Date, Time

ON DEVICE: Though there is no restriction for any date and time you set as current, please enter your location's current date and time to avoid any confusion; once the device is registered or linked to a user account, the date and time on the device will automatically update to the current time associated with the user account.

Time: 03 : 16 am

Date: YEAR 2016 MONTH 03 DAY 25

Date Format: MM/DD/YYYY

APP or WEBPAGE: The date and time for the device as well as the user account will automatically update by selecting the time zone for the device.

2. Heating Type

Select your home's heating type from the options available:
Gas/Oil, Electric, or Heat Pump

Heat Pump system?

You must also select Cool or Heat for **the reversing valve to be energized in.**

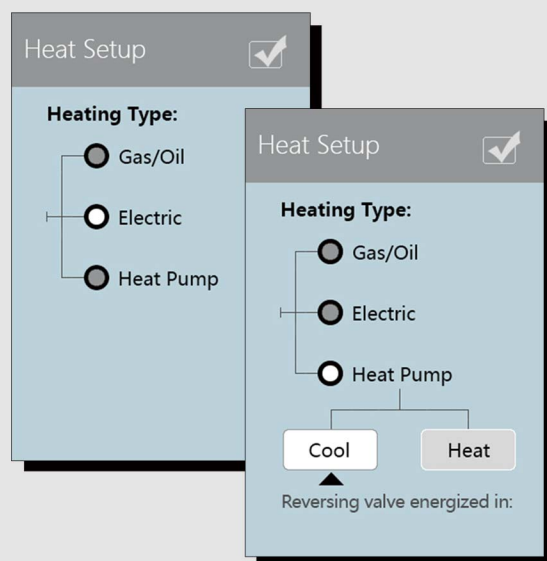

Please check your heating and cooling system manual or consult with a professional HVAC technician if you do not know which option to select.

This thermostat doesn't support Fan-Coil or multi-stage heating/cooling systems.

3. Mode

The thermostat comes with two default programs (**Summer-01** and **Winter-01**) for your convenience; select the one that fits your current needs. More programs can always be added using the App or Web Page.

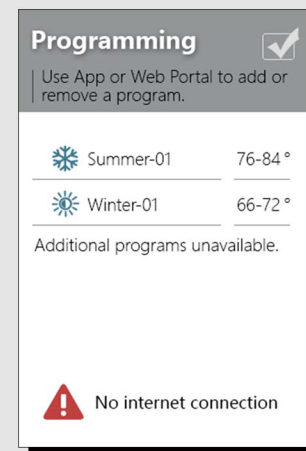

4. Wi-Fi Setup

You must have a proper Wi-Fi connection in order to access smart features such as App remote access, weather forecast and more. Please follow on-screen instructions to complete the Wi-Fi setup. More information on Wi-Fi connections can be found on the next page.

After a successful connection, the message that the device has not been registered by any user will be shown. You can now add the device to a user account after downloading the App and setting up an account.

MENU ACCESS

Date & Time

Main Menu -> Preference -> Date & Time

Heating Type

Main Menu -> Programming -> Heating Setup

Mode

Main Menu -> Programming -> Programs -> Go

Wi-Fi Setup

Main Menu -> Connection -> Wi-Fi

Wi-Fi Setup

Wi-Fi Connection



Tap the Wi-Fi icon to enter the Wi-Fi setup screen, then tap the Scan icon to generate available Wi-Fi networks. Follow on-screen instructions to complete the Wi-Fi setup.

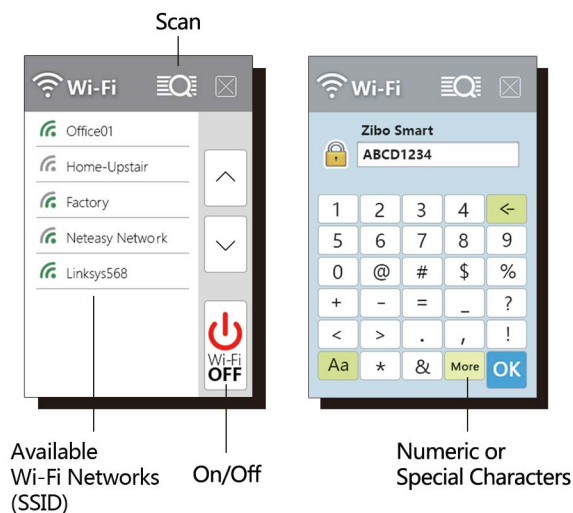

The password is limited to 17 characters in length. If no password is required, press OK to continue.

The following may cause a failed connection to the device:



- 1) Wi-Fi signal is too weak or 5G Wi-Fi network;
- 2) SSID contains space or non-ASCII characters;
- 3) Double check your password and try again;
- 4) Wi-Fi is okay but your internet is unavailable;
- 5) Requires additional webpage authentication.

If no password is required, press OK to continue.

User Account for the device

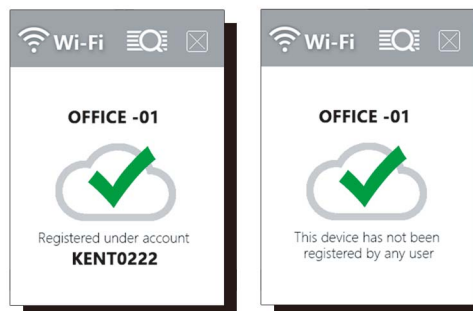

After a successful connection, an account ID will appear for the network the device has been added to.

For an unregistered device, it will display the message that the device needs to be registered.

Follow instructions on the next page to add the device to your account after downloading the App and setting up an account.

Auto Reconnect

If your device loses connection with your wireless network, it will automatically attempt to reconnect after five minutes. If that fails, it will make a new attempt every 15 minutes for the next 24 hours. Any manual operation of the thermostat will stop automatic reconnection attempts.

Wi-Fi can be manually turned off or on. Turning off your Wi-Fi will also disable the internet connection and all smart features, including App access to the device.

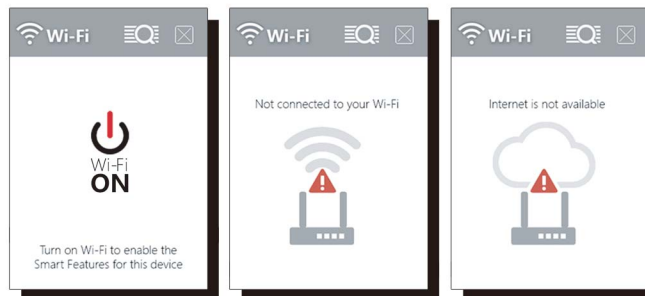

Members of a family need to share an account in order to gain access to the thermostat.

App Setup

Congratulations! You are now ready to use the thermostat. Now set up your App to enjoy exciting smart features.

Step 1: Download

iOS / Android App Download



There are three ways to download the Vine App for your smart device:

- 1) Search **Vine Smart Control** in the App Store or Google Play Store, then download;
- 2) Use your smart device to scan the QR code on the left for an automatic download;
- 3) Go to **www.vineconnected.com**, click **App** from the menu to download.

Step 2: Create a User Account

After installing the App onto your smart phone or touch pad, create a user account. The user account can also be created through the home page on our website.

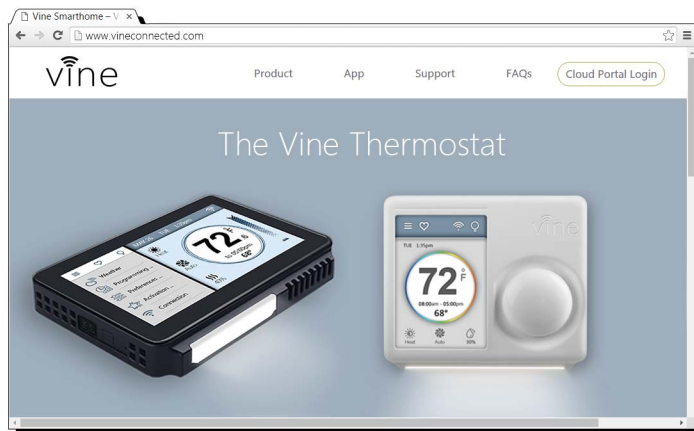

Step 3: Add Device to your Account



Log in to your account: tap "Add Device" on the device list screen, then simply follow on-screen instructions in the App or Webpage to complete this task. You will be asked to enter the MAC-ID and the Temporary Verification Code.

Wi-Fi Status Screen

MENU ACCESS

- > Main Menu
- > Wi-Fi Connection
- > Registration Info.

MAC-ID and Verification Code

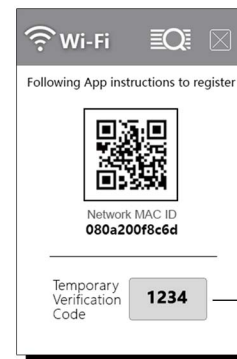

Once the device is connected to the internet, you'll be able to read the **Temporary Verification Code (TVC)** and **MAC ID** from the Wi-Fi Status screen.

Tap the TVC code to generate a new one when the previous code expires.

The MAC ID is a unique network ID for this device; this helps to identify your device over the internet.

The Temporary Verification Code (**TVC**) is a 4-digit code randomly generated each time you enter this screen. It expires after 90 seconds, upon which a new one will be needed.



During technical support, the TVC also functions as the verification of "the user currently in possession of the device".

Scan the QR code on the screen for your convenience

Mode Setup

System
Modes

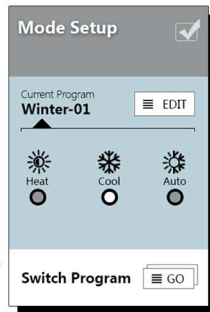
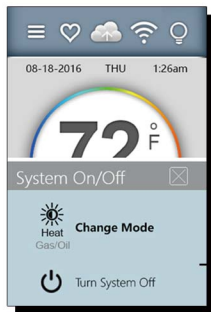

Tap the system mode icon on the home screen to enter Mode Setup, then tap **Program** or go to **Main Menu -> Programming -> Programs**

Please note that your device is always "running a program" and the current operation mode is part of that program. Thus, to change the current mode will also update the mode setting in the current program.



You can opt to turn the System Off to shut down all HVAC operations including fan operation.

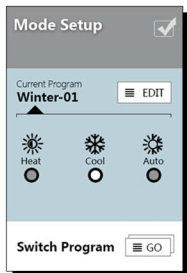

The mode selection is for the current program (Winter-01) as a whole. You can't assign different modes within a program.

Tap "Edit" to enter the Programming screen (detailed instructions shown on the next page).

Tap "Go" to enter a list of available programs on your account from the Cloud. From there, you can switch to a different program.

Programming

Temporary Adjustment

You can override the current program by tapping the Tower to adjust the temperature. A permanent override will ensue if you select Hold; otherwise it will be temporary, meaning that the override expires when the next scheduled program begins.

HOLD

CANCEL



Programming with the App

From the main menu in the App, select programming:

- 1) Tap a day of the week;
- 2) Scroll left and right to the column you want to change;
- 3) Simply drag the color bar Up and Down to change the temperature;
- 4) To create a new setpoint, tap on a time column, then move the rest of the color bar section up and down;
- 5) To delete a setpoint, merge the color bar with the one before or after.

Programming on the Thermostat

Home Screen -> Mode -> Change Mode

Tap **EDIT** or **GO** to change the program setting or select another program.

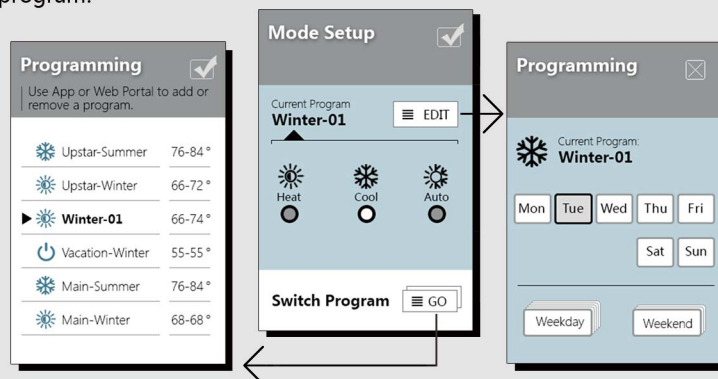

Program List:

There are only two default programs available for selection when the device is offline. Please follow instructions on the App or Webpage to create new programs or to delete an existing one.

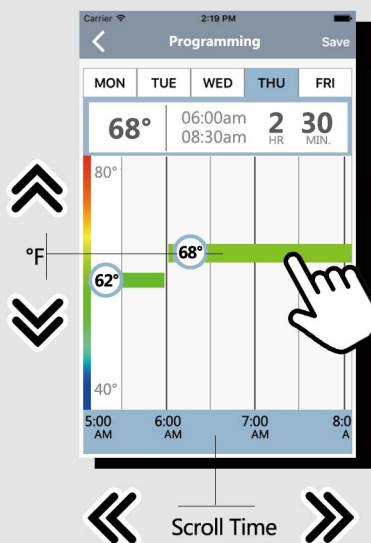

VIEW: View the program in either Graphic or List View.

SET: Set up specific setpoints (temperature and time).

COPY: Copy the setpoints to other days of the week.

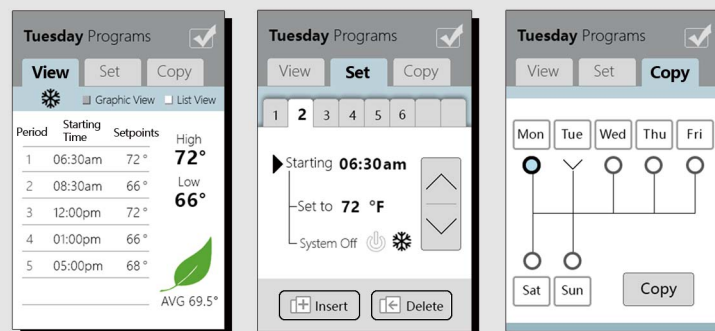

Programming Steps:

- STEP 1:** Select a **period** (total of 8 available per day) to change.
- STEP 2:** Set **Starting** Time increments by 15-minute intervals.
- STEP 3:** Select desired **temperature** or System Off for the period.

INSERT Inserts a new period before the current one.

DELETE Deletes the current period, merging the time with the next period.

Webpage Programming

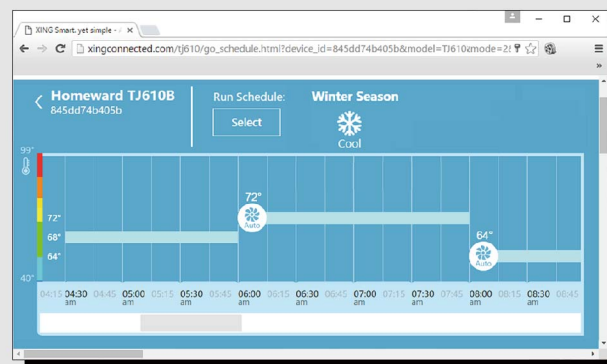

Log in to your account on the Webpage, select Programming from the user menu:

- 1) Select a program, then tap a day;
- 2) Scroll left and right to the column you want to change;
- 3) Simply drag the color bar Up and Down to change the temperature;
- 4) To create a new setpoint, tap on a time column, then move the rest of the color bar up and down;
- 5) To delete a setpoint, merge the color bar with the one before or after.

Additional Features

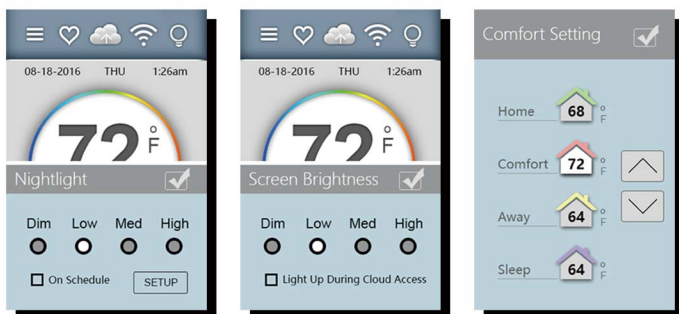

Nightlight

Nightlight can be programmed to turn on and off on a fixed daily schedule.

Screen

There are 4 levels of screen brightness.

EZ Comfort

EZ Comfort allows you to choose from four adjustable presets for your convenience. Tap the heart icon on the home screen to enter the EZ Comfort screen.

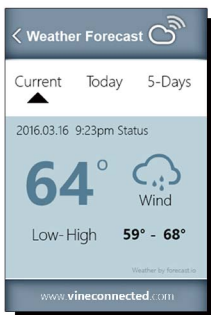

Weather Forecast

The weather forecast is based on the physical location of the thermostat.

When you use the App to add the device to your account, the location will automatically be assigned. You can also assign or change the location after you log in to your account on the App or webpage.

Fan Operation

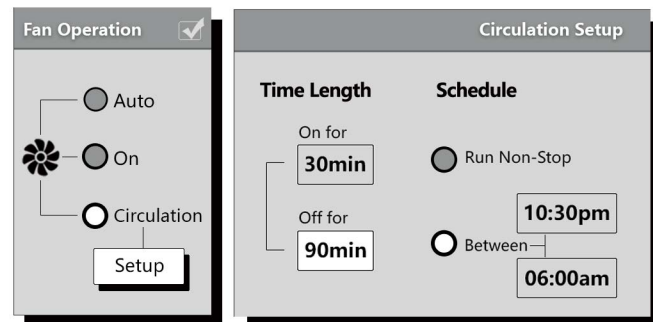

Auto

Fan will follow heating and cooling operations.

On

Fan runs non-stop for 24 hours*.

Circulation

Fan runs on and off regularly in addition to heating and cooling operations*.

By selecting this option, you also need to define the operation time length and schedule for the circulation.

***If the G wire was substituted for the C wire during installation, the Fan-On & Circulation options will not function.**

Temperature Alerts and Auto-On

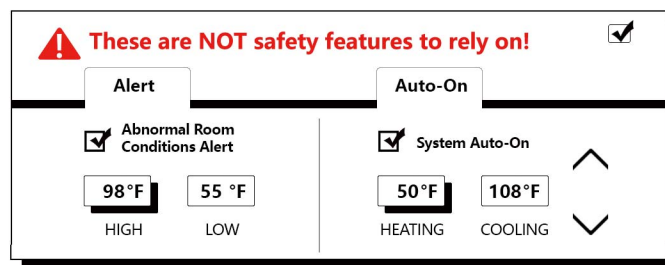

Alert

Send alert message when room temperature is out of the range between high and low.

Auto-On

Turn system on automatically when the room reaches these setpoints while the system is off.

Messages will be sent to your account and can be viewed on the device, App and Webpage.

Activation

Activation provides direct access to many common features; it is also the entry point to advanced features for the device. Activation is designed for professionals who want to utilize advanced features for better accessibility.

- AB** Auto-mode Switch Band *
Set difference for auto switch between heating/cooling
- AI** Account Information
Information about the user for whom device is registered
- HR** Help Resources
Resources for service and support
- HT** Heating Setup
Set up heating type and valve for heat pump system
- IS** Initialization Setup
Step by step guide to set up thermostat for first time
- MS** System Message
System generated notices and alerts
- PM** Parameter Modifier *
Advanced settings for system key parameters
- SC** Sensor Calibration *
To calibrate or correct the device temperature reading
- SD** System Default *
Restore system to default setting
- SI** System Information
Display hardware and software info for the device
- SL** System Lock/Unlock
Lock the thermostat to prevent on-device operation
- ST** Screen Timeout *
Set timeout length for screen auto-off during inactivity
- SU** System Update *
Manually update system software
- VC** Verification Code
Display a 4-digit temp. code for verification purposes
- WF** Additional Wi-Fi Options
Turn Wi-Fi on/off to enable or disable internet connection
- ZB** Zero Energy Band *
The temperature range where no heating or cooling is activated during operation

* For Professional Operation Only
Some feaures listed are only for Model TJ-919

Advanced Features *

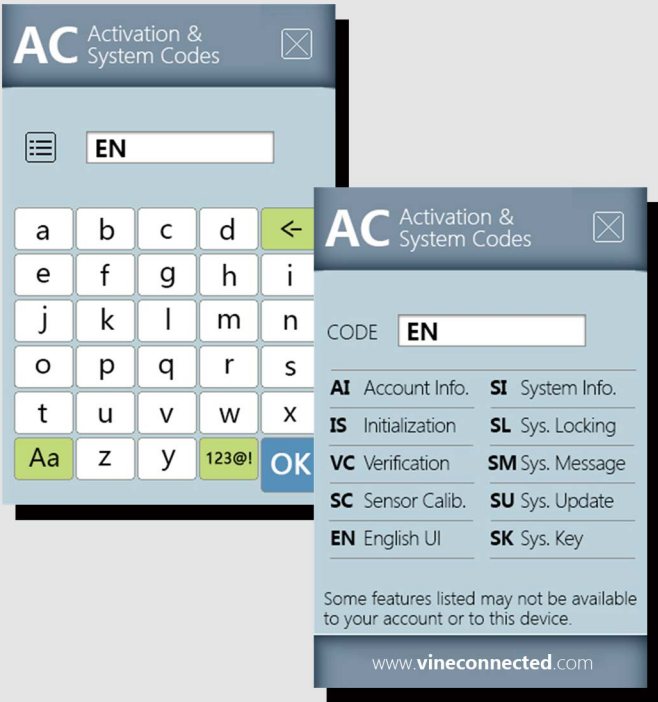

YouTube Channel
Vine Smart Home

Email
info@vineconnected.com

www.vineconnected.com

Telephone
1-800-264-3457 (9am-5pm PST)

Xing Connected Corp.
Pleasanton, California USA

THIS DOCUMENT CONSISTS OF IMPORTANT LIMITED WARRANTY INFORMATION REGARDING YOUR CLAIMS AND ACCOUNTABILITY, AS WELL AS RESTRICTIONS AND EXCLUSIONS THAT MAY APPLY TO YOU.

1. WHAT THIS LIMITED WARRANTY ENTAILS; DURATION OF COVERAGE

Xing Connected, Pleasanton, California USA, warrants to the owner of the enclosed product that the product contained in this box will be free from defects in materials and workmanship for a period of two years from the date of delivery following the original retail purchase. If the Product fails to conform to this Limited Warranty during the Warranty Period, Xing Connected will, at its sole discretion, either (a) repair or replace any defective Product or component; or (b) accept the return of the Product and refund the money actually paid by the original purchaser for the Product. Repair or replacement may be made with a new or refurbished product or components, at Xing Connected's sole discretion. If the Product or a component incorporated within it is no longer available, Xing Connected may, at its sole discretion, replace the Product with a similar product of similar function. This is your sole and exclusive remedy for breach of this Limited Warranty. Any Product that has either been repaired or replaced under this Limited Warranty will be covered by the terms of this Limited Warranty for the longer of (a) ninety days from the date of delivery of the repaired Product or replacement Product, or (b) the remaining Warranty Period. This Limited Warranty is transferable from the original purchaser to subsequent owners, but the Warranty Period will not be extended in duration or expanded in coverage for any such transfer.

2. TOTAL SATISFACTION RETURN POLICY

If you are the original purchaser of the Product and you are not satisfied with this Product for any reason, you may return it in its original condition within thirty days of the original purchase and receive a full refund.

3. WARRANTY TERMS; HOW TO RECEIVE SERVICE IF YOU WANT TO CLAIM UNDER THIS LIMITED WARRANTY

Before making a claim under this Limited Warranty, the owner of the Product must (a) notify Xing Connected of the intention to claim by visiting vinesmarthome.com/support during the Warranty Period and providing a description of the alleged failure, and (b) comply with Xing Connected's return shipping instructions. Xing Connected will have no warranty obligations with respect to a returned Product if it determines, in its reasonable discretion after examination of the returned Product, that the Product is an Ineligible Product (defined below). Xing Connected will bear all costs of return shipping to owner and will reimburse any shipping costs incurred by the owner, except with respect to any Ineligible Product, for which owner will bear all shipping costs.

4. WHAT THIS LIMITED WARRANTY DOES NOT COVER

This Limited Warranty does not cover the following ("Ineligible Products"): (i) Products marked as "sample" or "Not for Sale", or sold "AS IS"; (ii) Products that have been subject to: (a) modifications, alterations, tampering, or improper maintenance or repairs; (b) handling, storage, installation, testing, or use not in accordance with the User's Guide or other instructions provided by Xing Connected; (c) abuse or misuse of the Product; (d) breakdowns, fluctuations, or interruptions in electric power or the telecommunications network; or (e) Acts of God, including but not limited to lightning, flood, tornado, earthquake, or hurricane; or (iii) any non-Xing Connected branded hardware products, even if packaged or sold with Xing Connected hardware. This Limited Warranty does not cover consumable parts, including batteries, unless damage is due to defects in materials or workmanship of the Product, or software (even if packaged or sold with the product). Xing Connected recommends that you use only authorized service providers for maintenance or repair. Unauthorized use of the Product or software can impair the Product's performance and may invalidate this Limited Warranty.

5. DISCLAIMER OF WARRANTIES

EXCEPT AS STATED ABOVE IN THIS LIMITED WARRANTY, AND TO THE MAXIMUM EXTENT PERMITTED BY APPLICABLE LAW, XING CONNECTED DISCLAIMS ALL EXPRESS, IMPLIED, AND STATUTORY WARRANTIES AND CONDITIONS WITH RESPECT TO THE PRODUCT, INCLUDING THE IMPLIED WARRANTIES OF MERCHANTABILITY AND FITNESS FOR A PARTICULAR PURPOSE. TO THE MAXIMUM EXTENT PERMITTED BY APPLICABLE LAW, XING CONNECTED ALSO LIMITS THE DURATION OF ANY APPLICABLE IMPLIED WARRANTIES OR CONDITIONS TO THE DURATION OF THIS LIMITED WARRANTY.

6. LIMITATION OF DAMAGES

IN ADDITION TO THE ABOVE WARRANTY DISCLAIMERS, IN NO EVENT WILL XING CONNECTED BE LIABLE FOR ANY CONSEQUENTIAL, INCIDENTAL, EXEMPLARY, OR SPECIAL DAMAGES, INCLUDING ANY DAMAGES FOR LOST DATA OR LOST PROFITS, ARISING FROM OR RELATING TO THIS LIMITED WARRANTY OR THE PRODUCT, AND XING CONNECTED'S TOTAL CUMULATIVE LIABILITY ARISING FROM OR RELATED TO THIS

LIMITED WARRANTY OR THE PRODUCT WILL NOT EXCEED THE AMOUNT ACTUALLY PAID FOR THE PRODUCT BY THE ORIGINAL PURCHASER.

7. LIMITATION OF LIABILITY

THE XING CONNECTED ONLINE SERVICES ("SERVICES") PROVIDE YOU INFORMATION ("PRODUCT INFORMATION") REGARDING YOUR XING PRODUCTS OR OTHER PERIPHERALS CONNECTED TO YOUR PRODUCTS ("PRODUCT PERIPHERALS"). THE TYPE OF PRODUCT PERIPHERALS THAT MAY BE CONNECTED TO YOUR PRODUCT MAY CHANGE FROM TIME TO TIME. WITHOUT LIMITING THE GENERALITY OF THE DISCLAIMERS ABOVE, ALL PRODUCT INFORMATION IS PROVIDED FOR YOUR CONVENIENCE, "AS IS", AND "AS AVAILABLE". XING CONNECTED DOES NOT REPRESENT, WARRANT, OR GUARANTEE THAT PRODUCT INFORMATION WILL BE AVAILABLE, ACCURATE, OR RELIABLE OR THAT PRODUCT INFORMATION OR USE OF THE SERVICES OR PRODUCT WILL PROVIDE SAFETY IN YOUR HOME. YOU USE ALL PRODUCT INFORMATION, THE SERVICES, AND THE PRODUCT AT YOUR OWN DISCRETION AND RISK. YOU WILL BE SOLELY RESPONSIBLE FOR (AND XING CONNECTED DISCLAIMS) ANY AND ALL LOSS, LIABILITY, OR DAMAGES, INCLUDING TO YOUR WIRING, FIXTURES, ELECTRICITY, HOME, PRODUCT, PRODUCT PERIPHERALS, COMPUTER, MOBILE DEVICE, AND ALL OTHER ITEMS AND PETS IN YOUR HOME, RESULTING FROM YOUR USE OF THE PRODUCT INFORMATION, SERVICES, OR PRODUCT. PRODUCT INFORMATION PROVIDED BY THE SERVICES IS NOT INTENDED AS A SUBSTITUTE FOR DIRECT MEANS OF OBTAINING THE INFORMATION. FOR EXAMPLE, A NOTIFICATION PROVIDED THROUGH THE SERVICE IS NOT INTENDED AS A SUBSTITUTE FOR AUDIBLE AND VISIBLE INDICATIONS IN THE HOME AND ON THE PRODUCT, NOR FOR A THIRD PARTY MONITORING SERVICE THAT MONITORS ALARM STATE.

8. YOUR RIGHTS AND THIS LIMITED WARRANTY

This Limited Warranty gives you specific legal rights. You may also have other legal rights that vary by state, province, or jurisdiction. Likewise, some of the limitations in this Limited Warranty may not apply in certain states, provinces or jurisdictions. The terms of this Limited Warranty will apply to the extent permitted by applicable law. For a full description of your legal rights you should refer to the laws applicable in your jurisdiction and you may wish to contact a relevant consumer advisory service.

LIMITED WARRANTY

Please visit our website for the complete disclosure of this statement